

Existing Axonometric

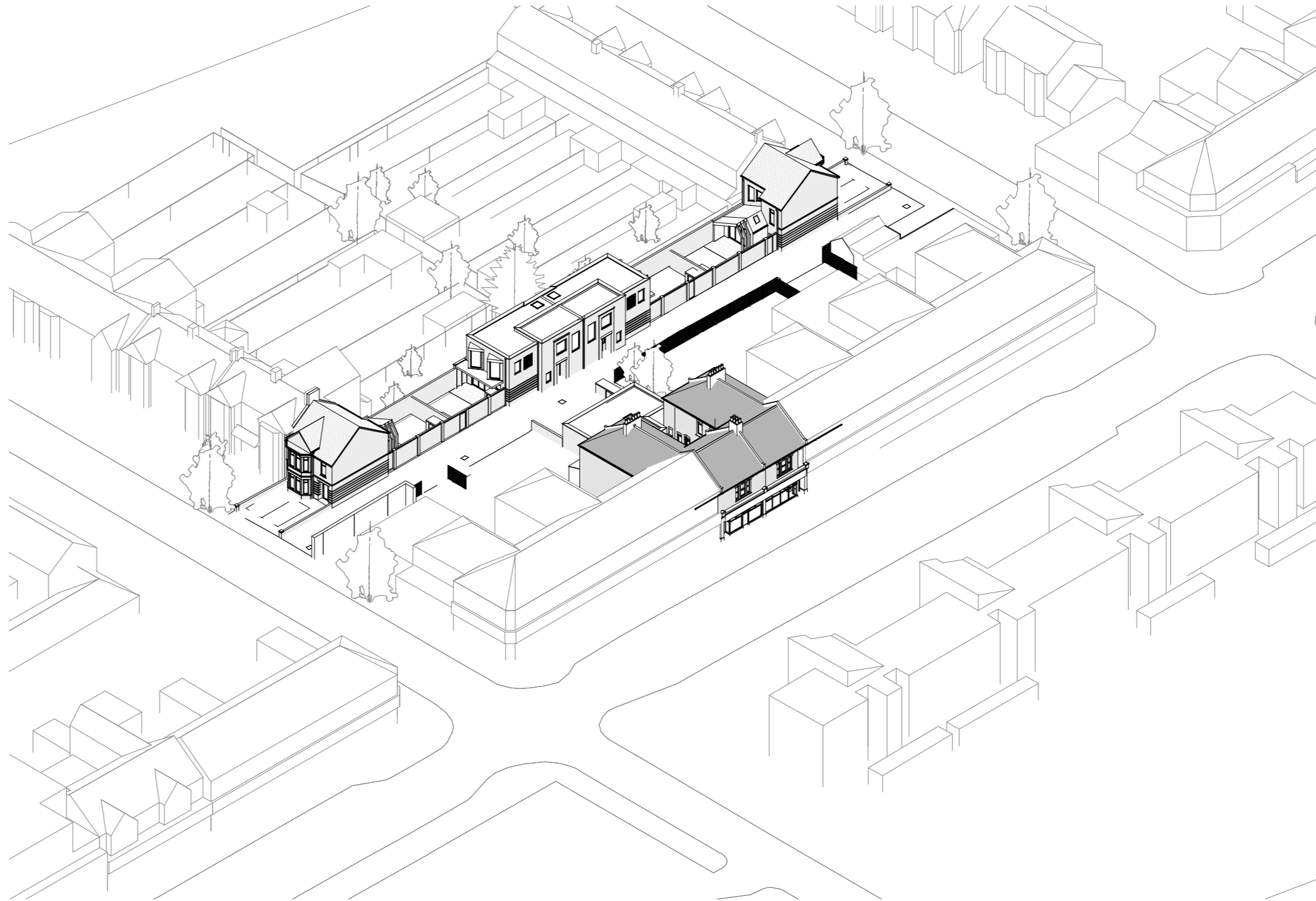

Proposed Axonometric

Notes
 This drawing may be scaled for the purposes of Planning Applications, Land Registry and for Legal plans where the scale bar is used, and where it verifies that the drawing is an original or an accurate copy. It may not be scaled for construction purposes.
 Always refer to figured dimensions. All dimensions are to be checked on site. Discrepancies and/or ambiguities between this drawing and information given elsewhere must be reported immediately to this office for clarification before proceeding. All drawings are to be read in conjunction with the specification and all works to be carried out in accordance with latest British Standards / Codes of Practice.

Rev	Date	Init	Notes	Chkd
B	23/04/21	SW	Revised Planning Issue	IS
A	14/01/21	DH	Proposed Flat Layout Mirrored	IS

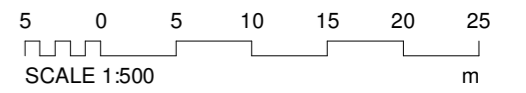

Client
CASTELNAU
 Strategic Property Investment

Drawing Originator
AWW inspired environments
 London - 106 Weston Street London SE1 3QB 020 7160 6000
 Bristol - Rivergate House, Bristol, BS1 6LS 0117 923 2535
 Plymouth - East Quay House, Plymouth, PL4 0HX 01752 261 282
 RIBA Chartered Practice www.aww-uk.com

Project Title
Southchurch Road
613-619 Southchurch Road
Southend SS1 2PN

Drawing Title
Existing and Proposed
Axonometric

Scale	Sheet	Drawn	Checked	Date
	A2	DH	IS	

Status	Project No.	
PLANNING	4370	
Drawing Reference	Drawing No.	Revision
SCR-AWW-A-DWG	0400	B